

PBSS5320T

Rev.F Apr.-2017

SOT-23

PNP

Silicon PNP transistor in a SOT-23 Plastic Package.

Low $V_{CE(sat)}$, high current.

General purpose switching and muting, LCD back-lighting, supply line switching circuits.

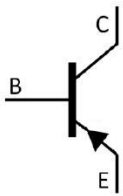

PIN 1 Base PIN 2 Emitter PIN 3 Collector

Parameter	Symbol	Rating	Unit
Collector to Base Voltage	V_{CBO}	-20	V
Collector to Emitter Voltage	V_{CEO}	-20	V
Emitter to Base Voltage	V_{EBO}	-5.0	V
Collector Current	I_C	-2.0	A
Peak Collector Current	I_{CM}	-5.0	A
Base Current	I_B	-0.5	A
total power dissipation	$P_{tot(1)}^2$	300	mW
total power dissipation	$P_{tot(2)}^{1\ 2}$	1.2	W
Junction Temperature	T_j	150	
Storage Temperature Range	T_{stg}	-55 150	

1 $tp \leq 100\ ms$ $\delta \leq 0.25$

2

Parameter	Symbol	Test Conditions	Min	Typ	Max	Unit
Collector Cut-Off Current	I_{CBO}	$V_{CB}=-20V$ $I_E=0$			-0.1	μA
		$V_{CB}=-20V$ $I_E=0$ $T_j=150$			-50	μA
Emitter Cut-Off Current	I_{EBO}	$V_{EB}=-5.0V$ $I_C=0$			-0.1	μA
DC Current Gain	$h_{FE(1)}$	$V_{CE}=-2.0V$ $I_C=-500mA$	220		450	
	$h_{FE(2)}$	$V_{CE}=-2.0V$ $I_C=-100mA$	220			
	$h_{FE(3)}$	$V_{CE}=-2.0V$ $I_C=-1.0A$	200			
	$h_{FE(4)}$	$V_{CE}=-2.0V$ $I_C=-2.0A$	150			
	$h_{FE(5)}$	$V_{CE}=-2.0V$ $I_C=-3.0A$	100			
Collector-Emitter Saturation Voltage	$V_{CE(sat)(1)}$	$I_C=-500mA$ $I_B=-50mA$			-100	mV
	$V_{CE(sat)(2)}$	$I_C=-2.0A$ $I_B=-100mA$			-300	mV
Equivalent on-resistance	$R_{CE(sat)}$	$I_C=-2.0A$ $I_B=-200mA$		125	150	m
Base-Emitter Saturation Voltage	$V_{BE(sat)}$	$I_C=-2.0A$ $I_B=-100mA$			-1.1	V
		$I_C=-3.0A$ $I_B=-300mA$			-1.2	V
Base-Emitter Voltage	$V_{BE(ON)}$	$V_{CE}=-2.0V$ $I_C=-1.0A$			-1.2	V
Transition Frequency	f_T	$V_{CE}=-5.0V$ $f=100MHz$ $I_C=-100mA$	100			MHz
Collector Capacitance	C_C	$V_{CB}=-10V$ $I_E=0$ $f=1.0MHz$				

/ Electrical Characteristic Curve

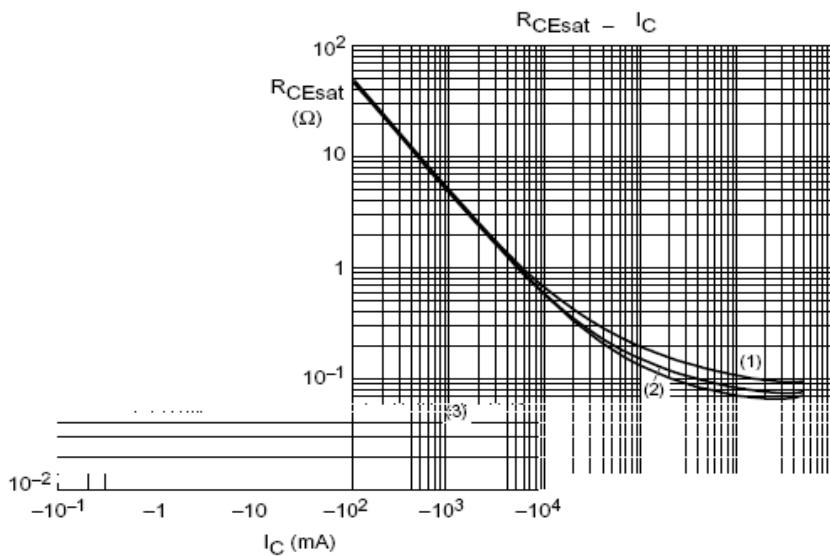
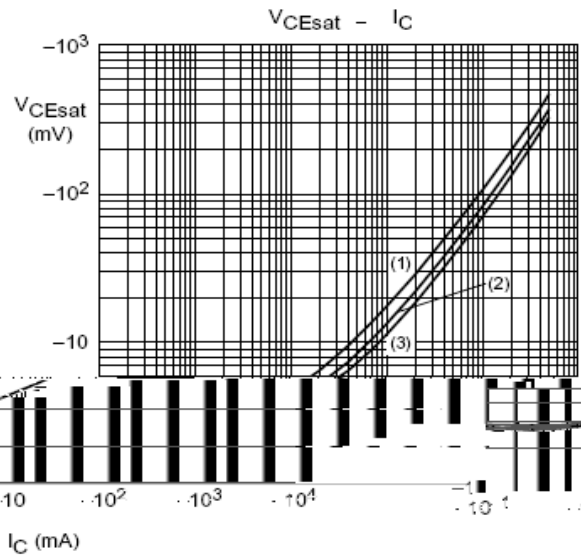
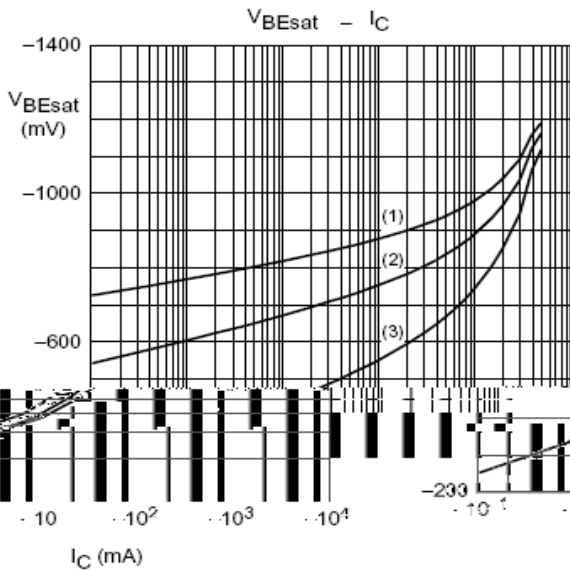
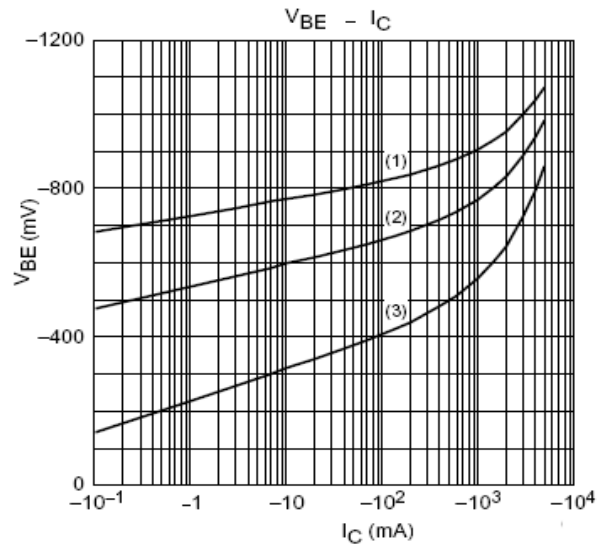
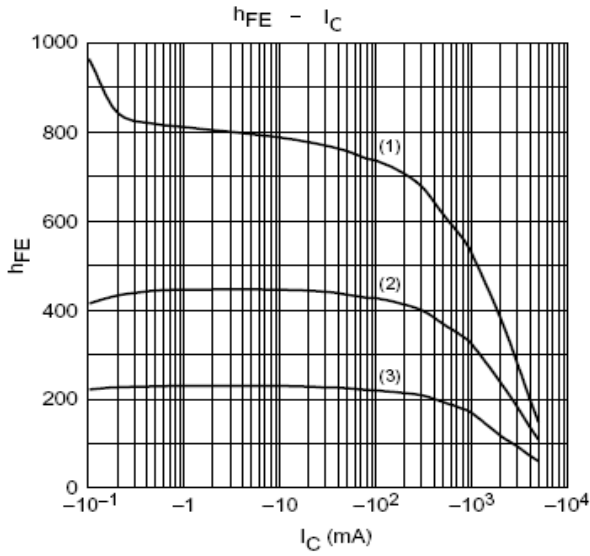

/ Package Dimensions

SOT-23

单位: mm

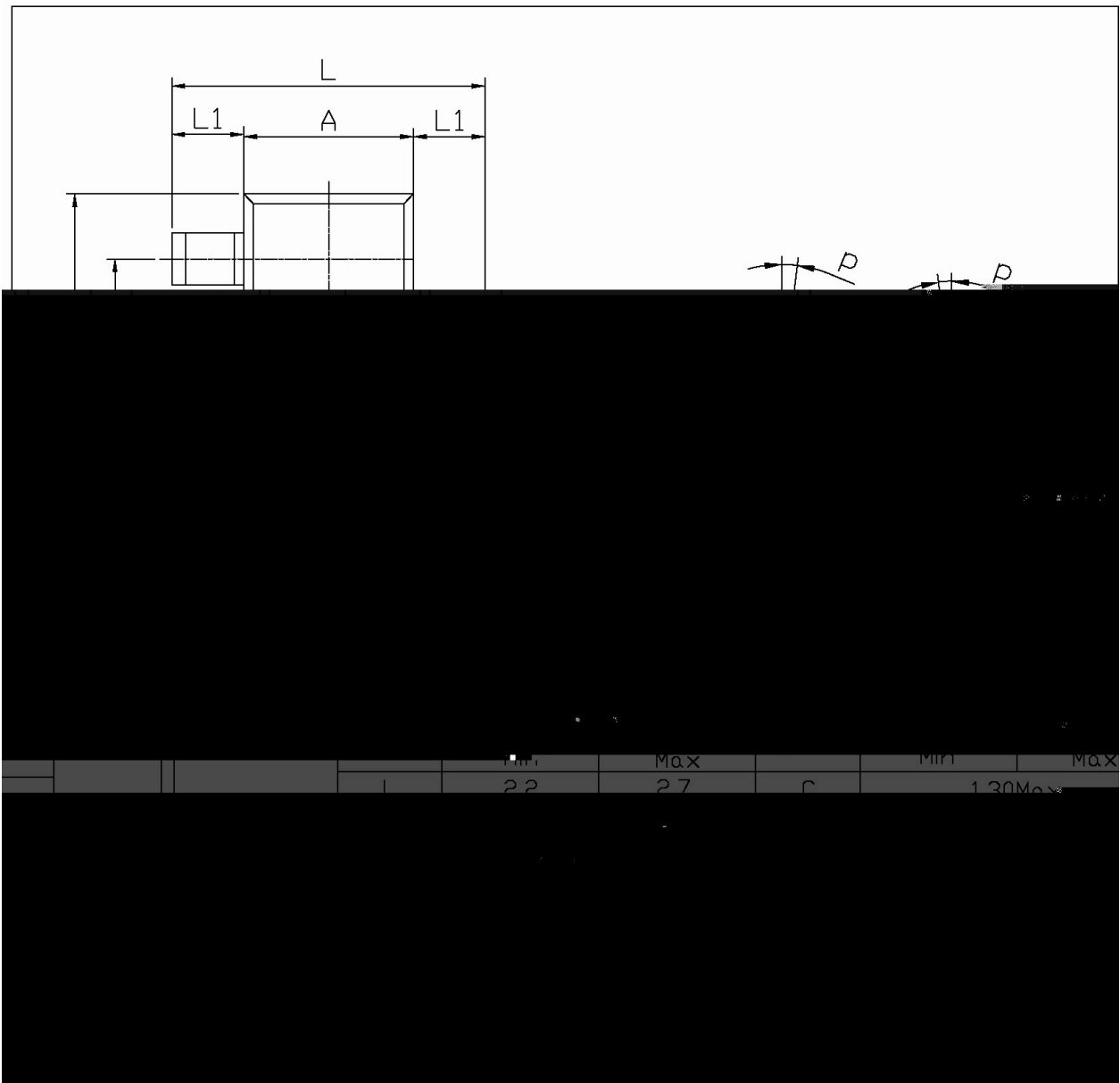

/ Marking Instructions

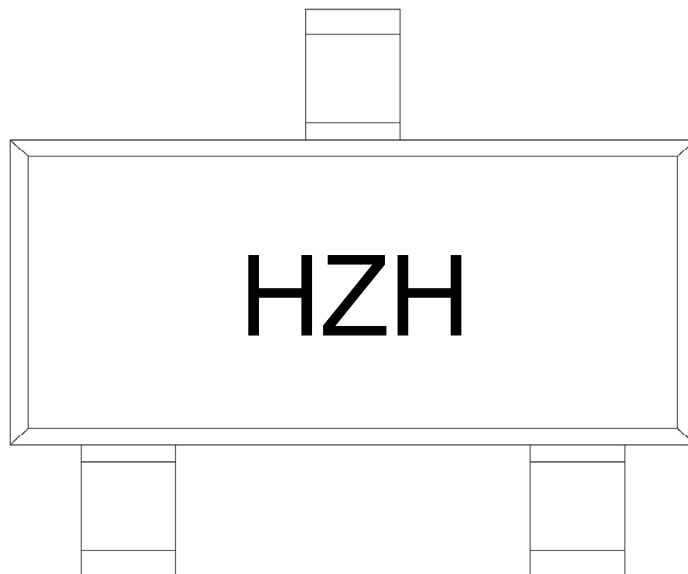

H

ZH

Note:

H Company Code

ZH Product Type

() /

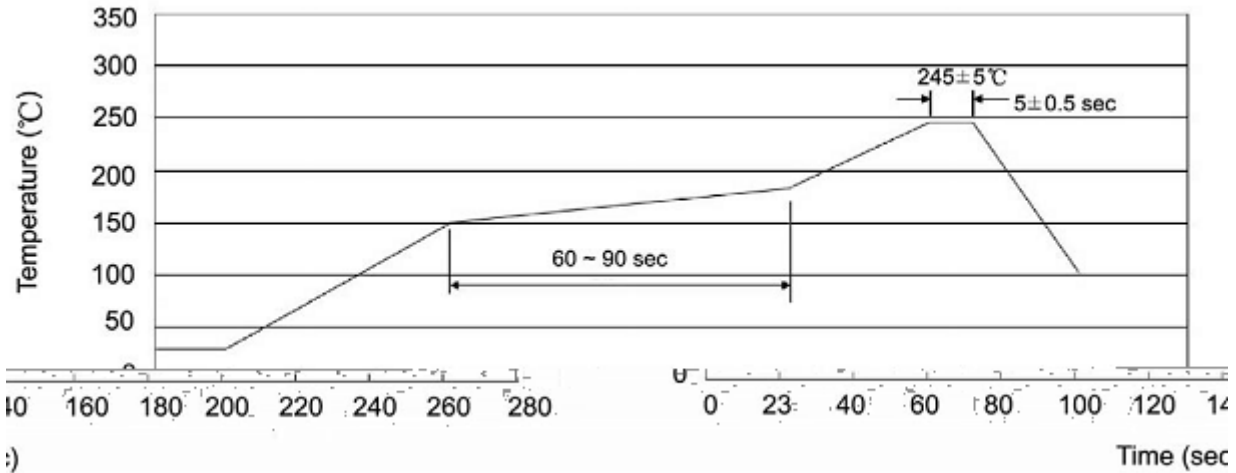

Note:

- | | | | | | |
|---|-------|-----|-----------|--------|---|
| 1 | 25 | 150 | 60 | 90sec; | 1.Preheating:25~150 , Time:60~90sec. |
| 2 | 245±5 | | 5±0.5sec; | | 2.Peak Temp.:245±5 , Duration:5±0.5sec. |
| 3 | | 2 | 10 | /sec. | 3. Cooling Speed: 2~10 /sec. |

/ Resistance to Soldering Heat Test Conditions

260±5 10±1 sec. Temp.:260±5 Time:10±1 sec

/ Packaging SPEC.

/ REEL

Package Type 封装形式	Units 包装数量					Dimension 包装尺寸 (unit: mm ³)		
	Units/Reel 只/卷盘	Reels/Inner Box 卷盘/盒	Units/Inner Box 只/盒	Inner Boxes/Outer Box 盒/箱	Units/Outer Box 只/箱	Reel	Inner Box 盒	Outer Box 箱
SOT-23	3,000	10	30,000	6	180,000	7 ×8	180×120×180	390×385×205

/ Notices