

# MUR860D

Rev.F Jun.-2016

## / Descriptions

TO-252

Ultrafast Recovery Diode in a TO-252 Plastic Package.

## / Features

Silicon epitaxial process to produce ultrafast recovery diode with low reverse leakage current and high reliability.

## / Applications

For use in low voltage, high frequency inverters, free wheeling, and polarity protection applications.

## / Equivalent Circuit

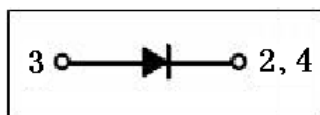

## / Pinning

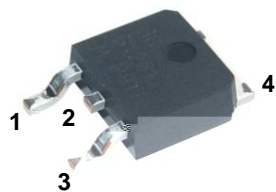

PIN1 NC

PIN 2 Cathode

PIN 3 Anode

PIN 4:Case

## / h<sub>FE</sub> Classifications & Marking

See Marking Instructions.

Parameter	Symbol	Rating	Unit
Peak Repetitive Reverse Voltage	$V_{RRM}$	600	V
Working Peak Reverse Voltage	$V_{RMS}$	420	V
Average Rectified Forward Current	$I_F$	8	A
Non Repetitive Peak Surge Current	$I_{FSM}$	125	A
Thermal resistance, junction to case	$R_{Jc}$	3.5	°C/W
Junction and Storage Temperature Range	$T_j$ $T_{stg}$	-55 150	°C

Parameter	Symbol	Test Conditions	Min	Typ	Max	Unit
Reverse Voltage	$V_{BR}$	$I_R=100\mu A$	600			V
Forward Voltage	$V_F$	$I_F=8A$ $T_c=25$		1.4	1.7	V
		$I_F=16A$ $T_c=25$		1.7	2.1	V
		$I_F$	1.7	2.1	V	

/ Electrical Characteristic Curve

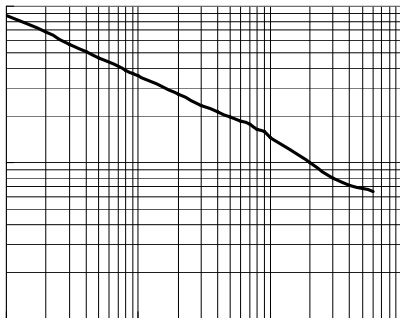
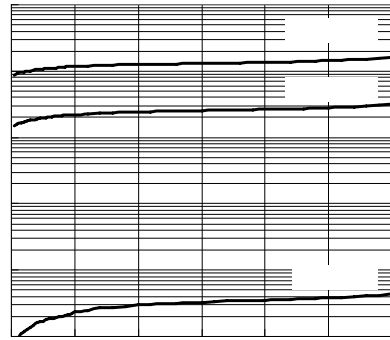
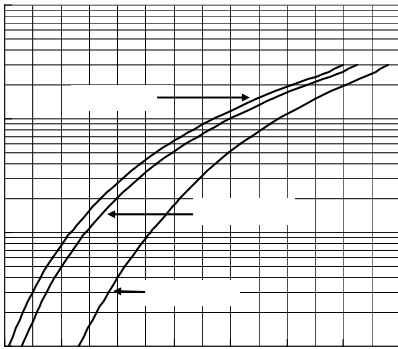
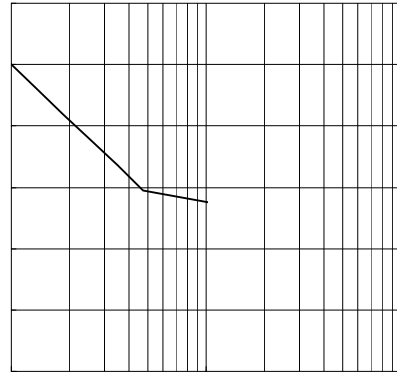
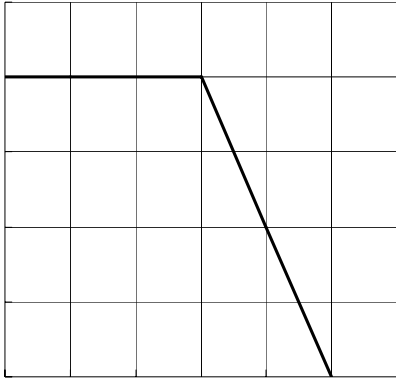

/ Package Dimensions

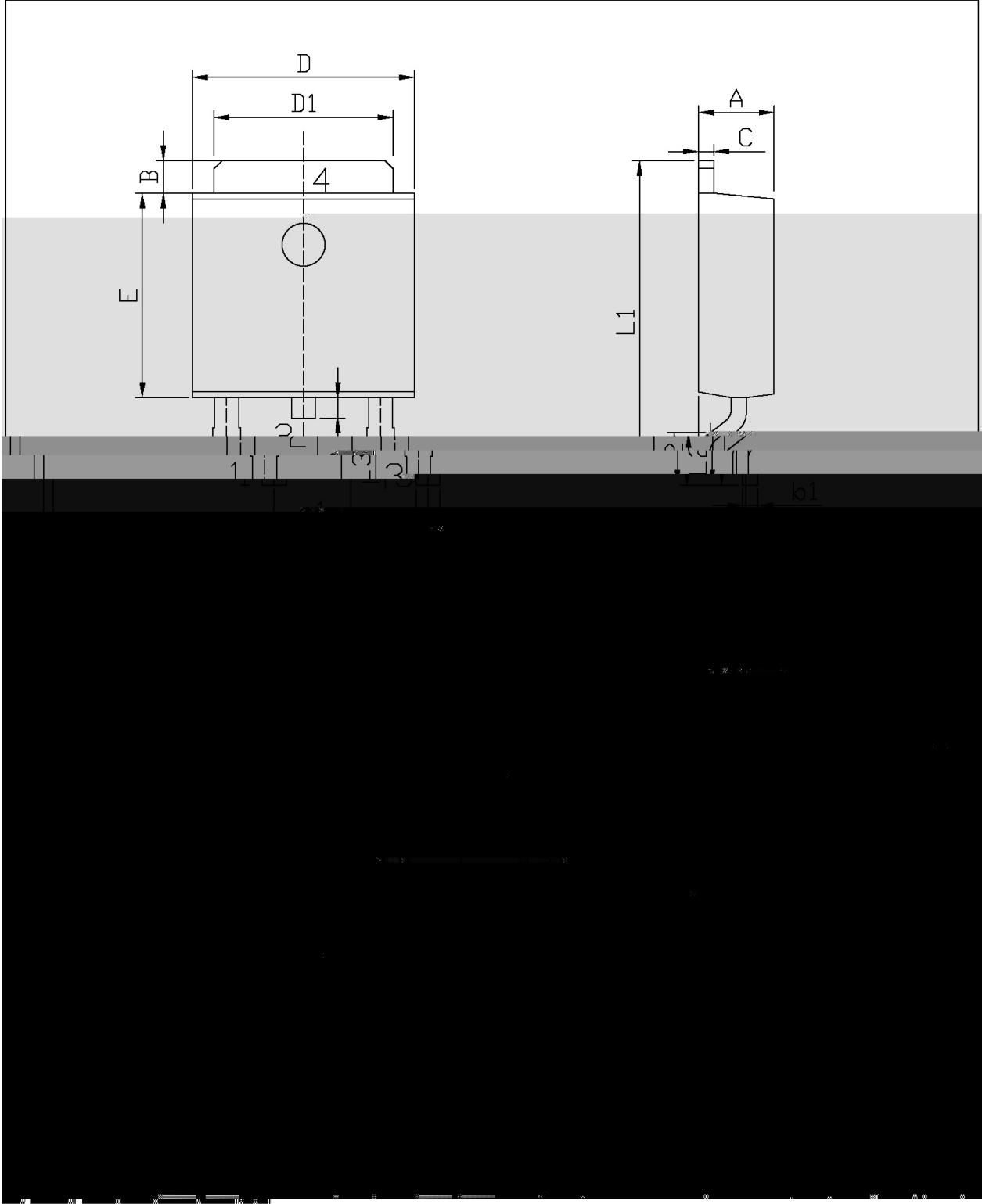

**/ Marking Instructions**

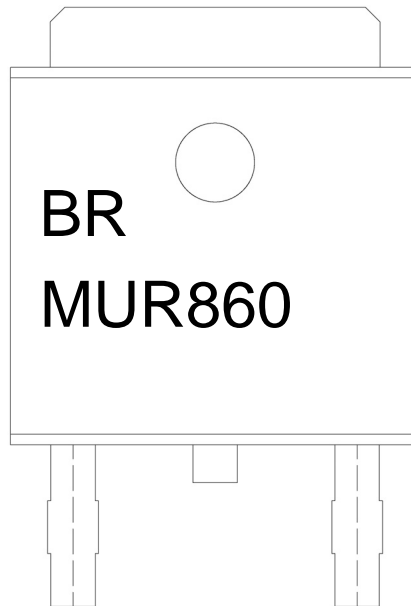

BR

MUR860

\*\*\*\*

**Note:**

BR:

Company Code

MUR860

Product Type.

\*\*\*\*:

Lot No. Code, code change with Lot No.

( ) /

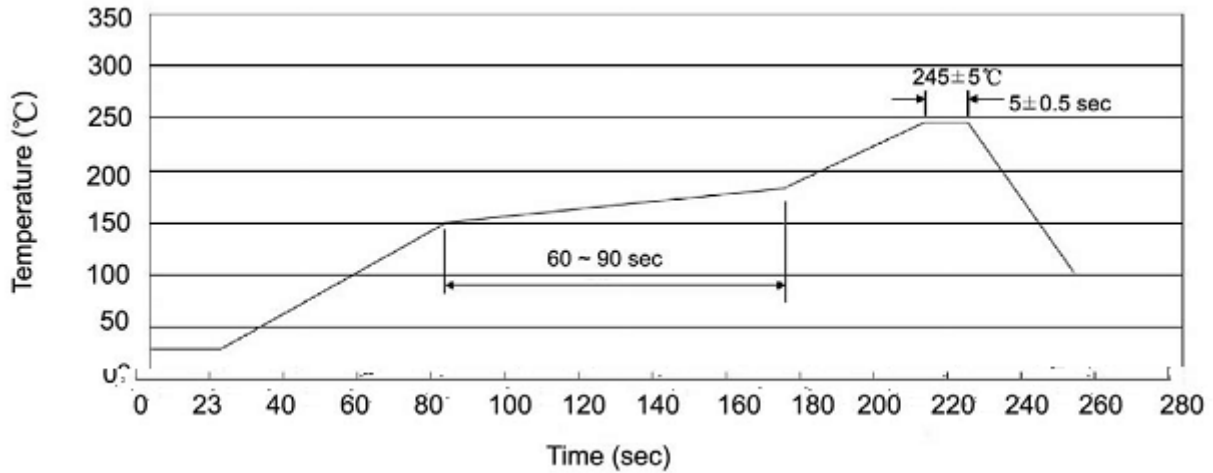

Note:

- |   |       |     |       |        |   |
|---|-------|-----|-------|--------|---|
| 1 | 25    | 150 | 60    | 90sec; | 1.Preheating:25~150 , Time:60~90sec.    |
| 2 | 245±5 |     | 5±0.5 | sec;   | 2.Peak Temp.:245±5 , Duration:5±0.5sec. |
| 3 |       | 2   | 10    | /sec.  | 3. Cooling Speed: 2~10 /sec.            |

**/ Resistance to Soldering Heat Test Conditions**

260±5                      10±1 sec.                      Temp.:260±5°C                      Time:10±1 sec

**/ Packaging SPEC.**

/ REEL

Package Type 封装形式	Units 包装数量					Dimension 包装尺寸 (unit: mm <sup>3</sup> )		
	只 卷盘	卷盘 盒	只 盒	盒 箱	只 箱		盒	箱

/ TUBE

Package Type 封装形式	Units 包装数量					Dimension 包装尺寸 (unit: mm <sup>3</sup> )		
	只 套管	套管 盒	只 盒	盒 箱	只 箱	套管	盒	箱

**/ Notices**