

/ Descriptions

TO-252

/ Features

/ Applications

/ Equivalent Circuit

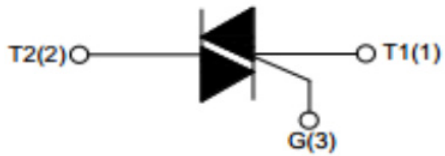

/ Pinning

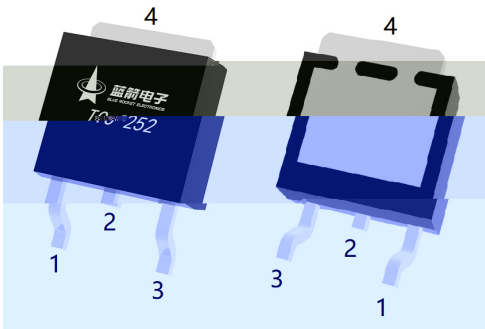

:

/ Marking

/ Absolute Maximum Ratings(Ta=25)

			μ
μ			
		~	°C
		~	°C
			°C

/ Electrical Characteristics(Tj=25)
4 / Snubberless and logic level 4 quadrants)

	°C			
		°C		μ
	μ	°C		
		°C		μ
		°C		

/ Electrical Characteristic Curve

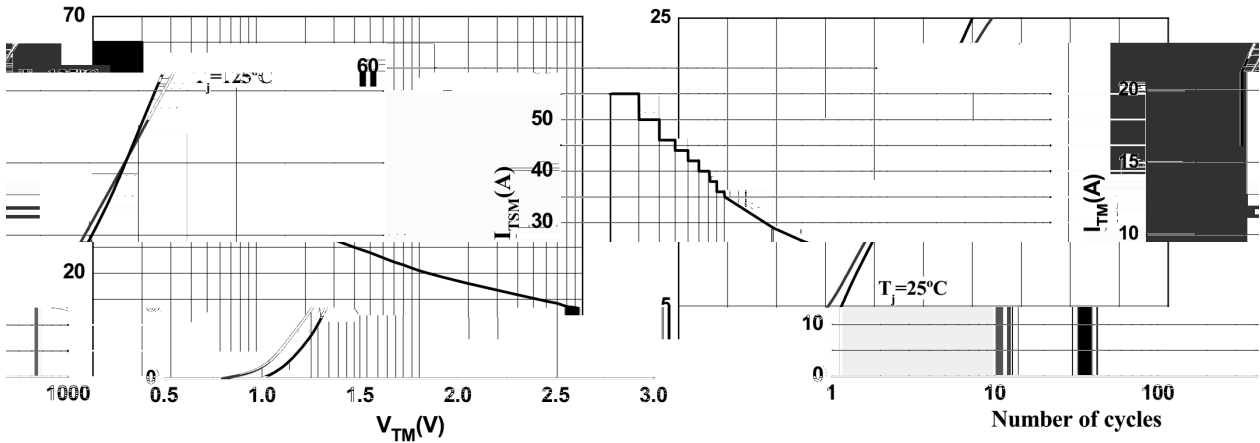
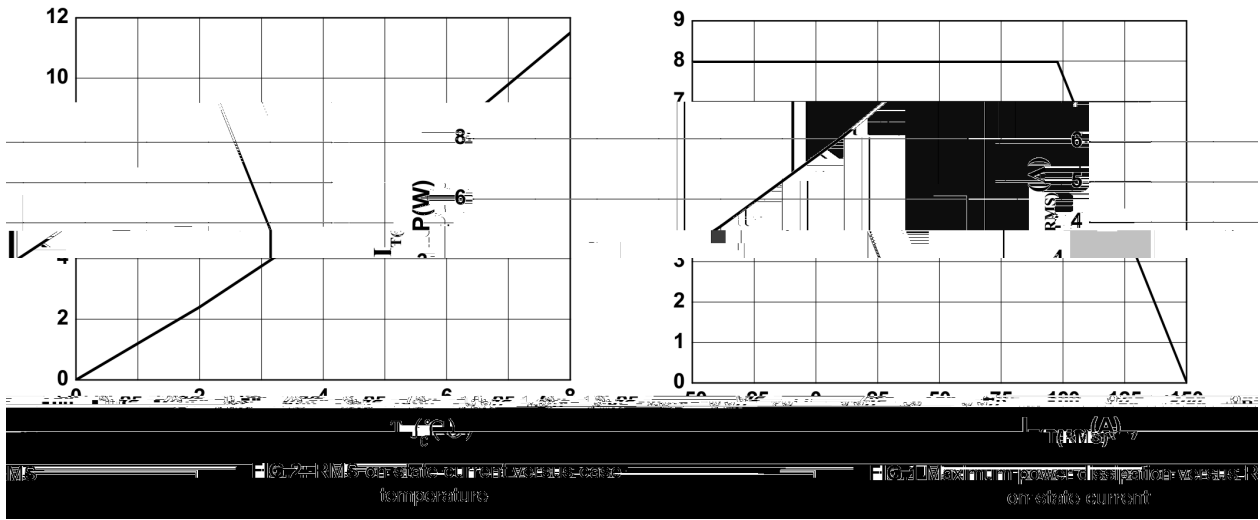

FIG.4: On-state characteristics

FIG.3: Surge peak on-state current versus number of cycles

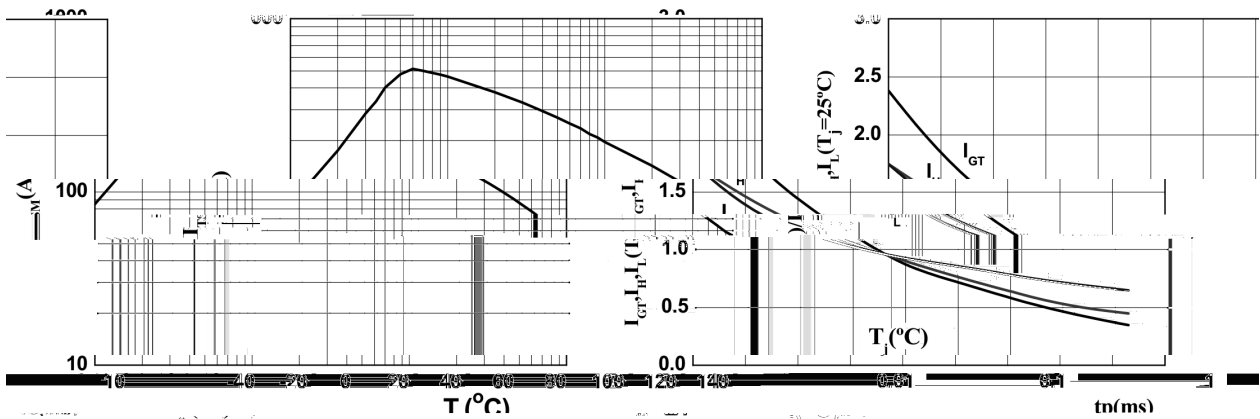
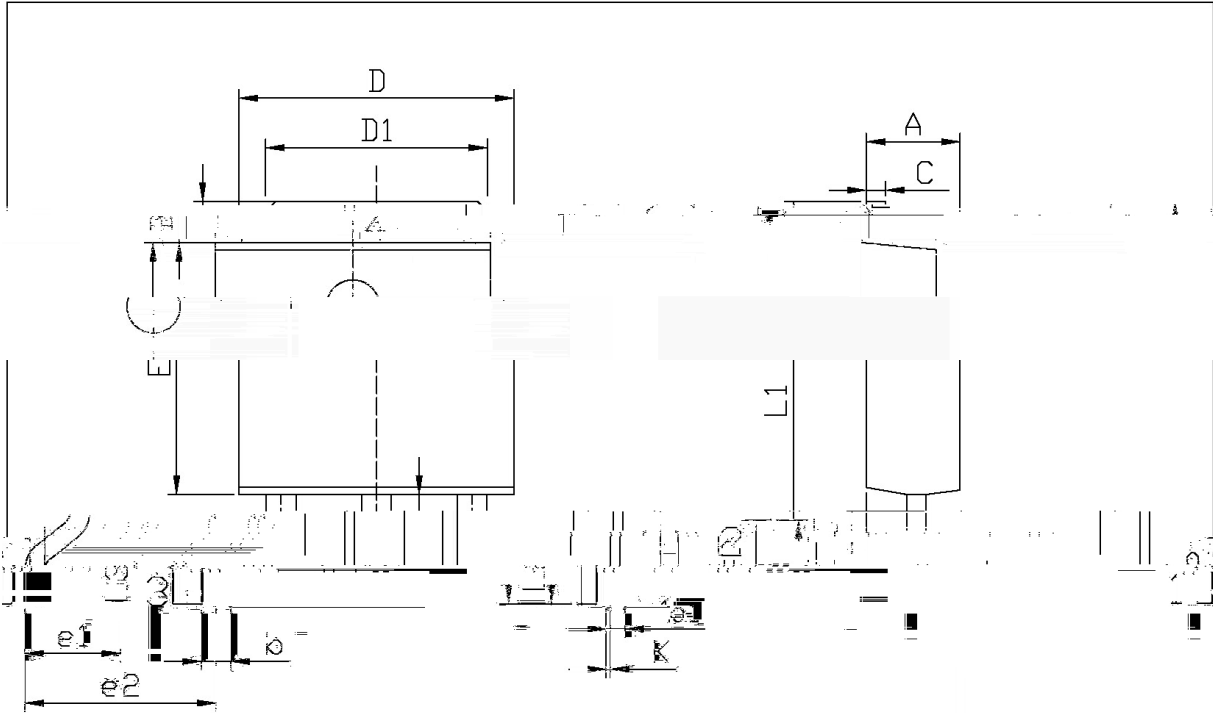

FIG.5: Non-repetitive surge peak on-state current

FIG.6: Relative variations of gate trigger

/ Package Dimensions



单位: mm

Symbol	Dimensions In Millimeters		Symbol	Dimensions In Millimeters	
	Min	Max		Min	Max
A	2.20	2.40	E	5.95	6.25
B	0.95	1.25	e1	2.24	2.34
b	0.50	0.90	e2	4.43	4.73
b1	0.45	0.55	L1	9.45	9.95
C	0.45	0.55	L2	1.25	1.75
D	6.45	6.75	L3	0.60	0.90
D1	5.10	5.50	K	0.00	0.10

TO-252

/ Marking Instructions

BR

BT0808

E

IGT

() /

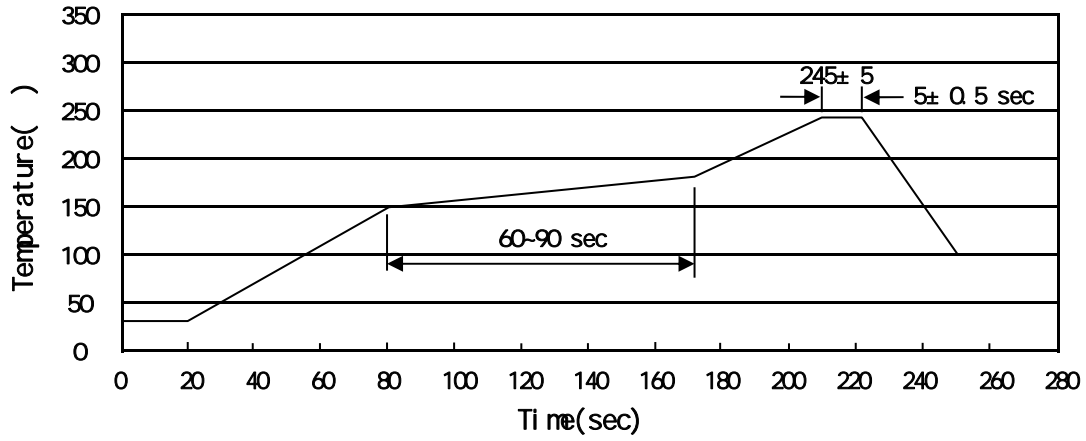

± ± ± ±

/ Resistance to Soldering Heat Test Conditions

± ± °C

/ Packaging SPEC.

						"		

/ Notices