

/ Descriptions

/ Features

1.5A,

/ Applications

/ / Equivalent Circuit or Application Circuit

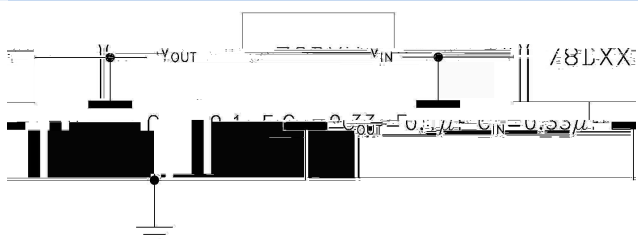

/ Pinning

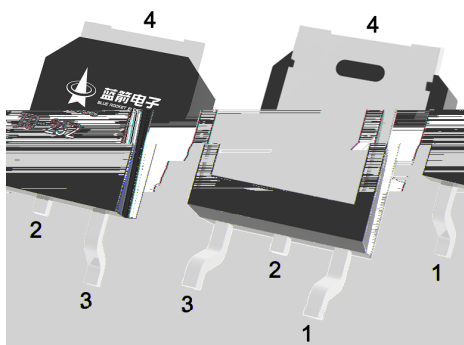

/ Marking

/ Absolute Maximum Ratings(Ta=25)

	θ		°C
	θ		°C
		~	°C
		~	°C

/ Electrical Characteristics(Ta=25 Vi=19V,Io=500mA unless otherwise specified)

		V_i				
	Δ	°C				
	Δ	°C				
	Δ	°C				
	Δ	°C				
	Δ					
	Δ Δ					°C
		°C				μ
		°C				
						Ω
		°C				
		°C				

/ Electrical Characteristic Curve

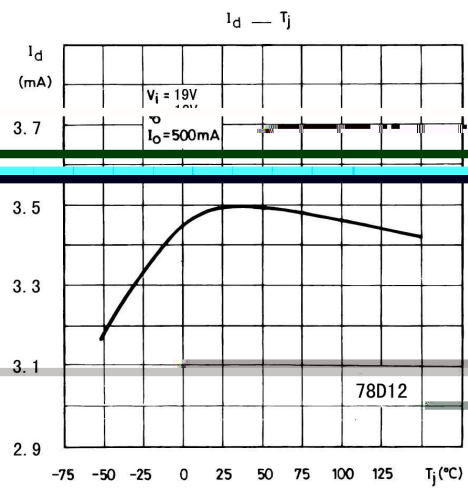
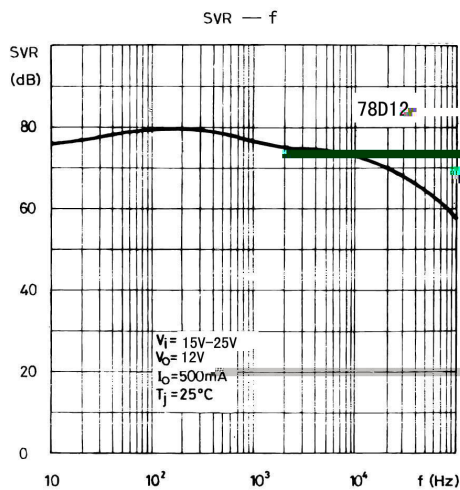
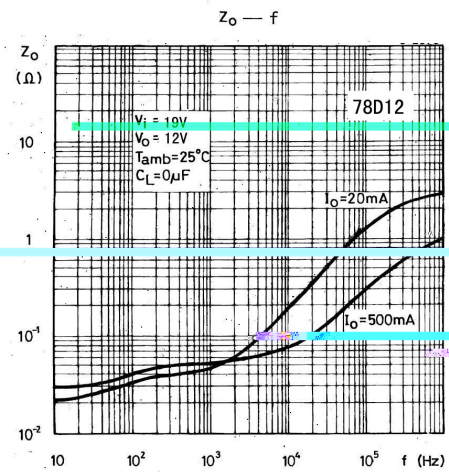
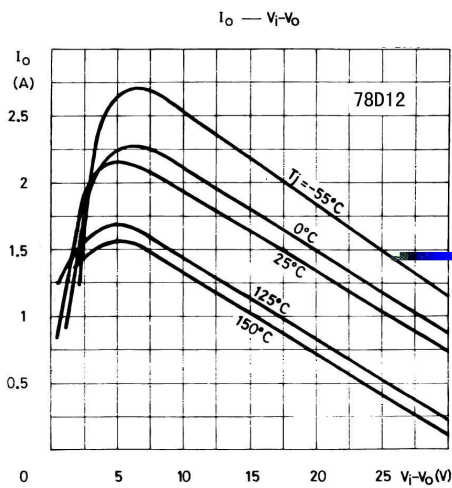
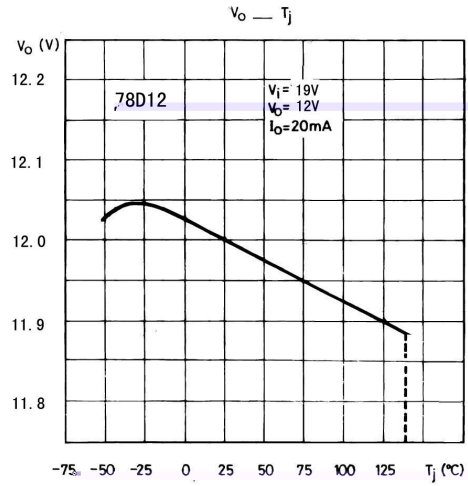
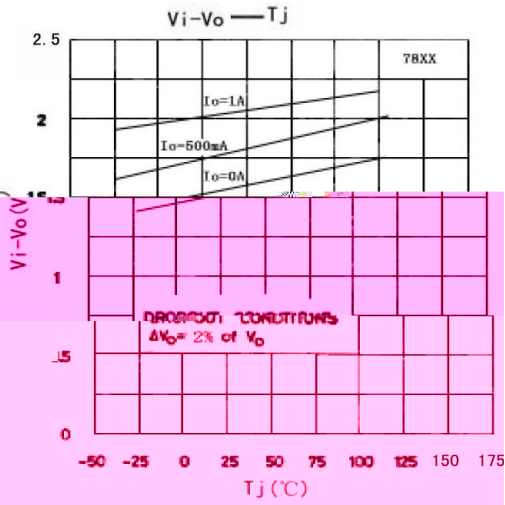

/ Package Dimensions

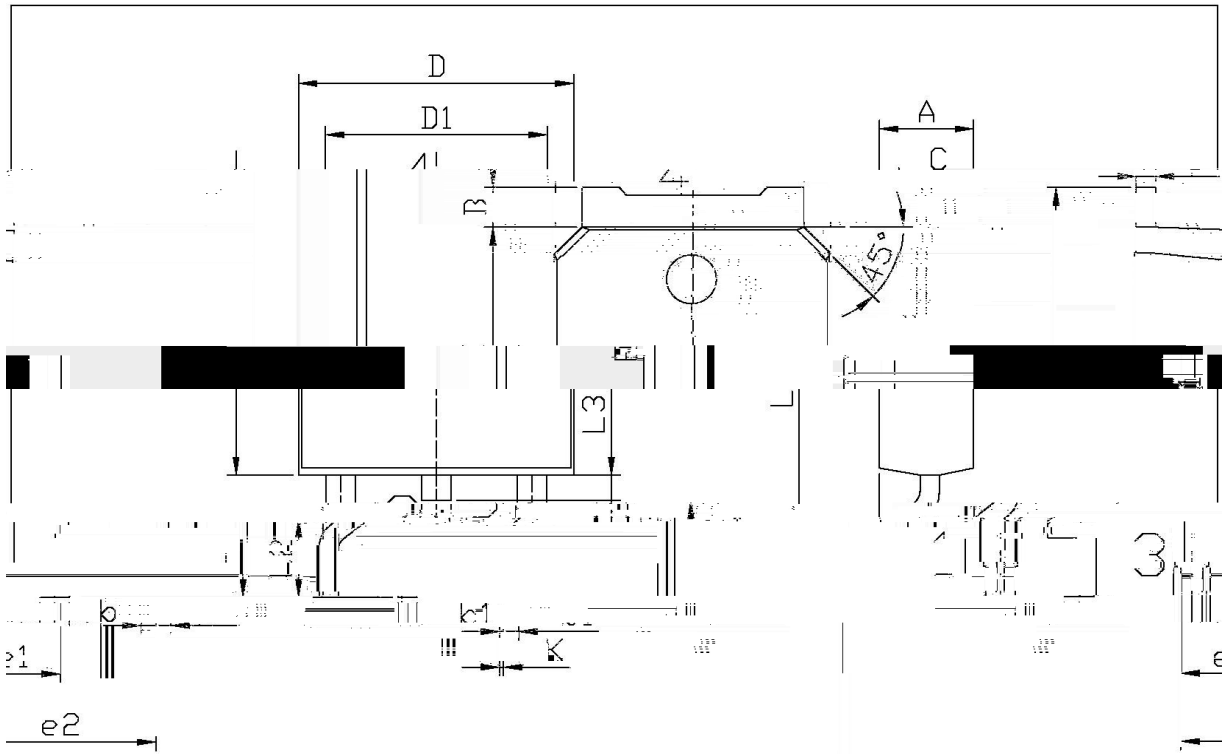

单位: mm

Symbol	Dimensions In Millimeters		Symbol	Dimensions In Millimeters	
	Min	Max		Min	Max
A	2.20	2.40	B	0.95	1.25
B	0.95	1.25	C	0.70	0.85
C	0.70	0.85	D	6.45	6.75
D	6.45	6.75	L1	9.85	10.35
D1	6.75	7.50	L3	0.60	0.90
L1	9.85	10.35	K	0.90	1.02

TO-252

/ Marking Instructions

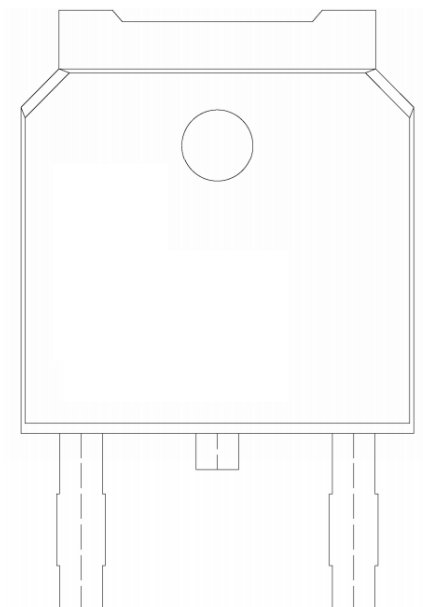

BR

78D12

() /

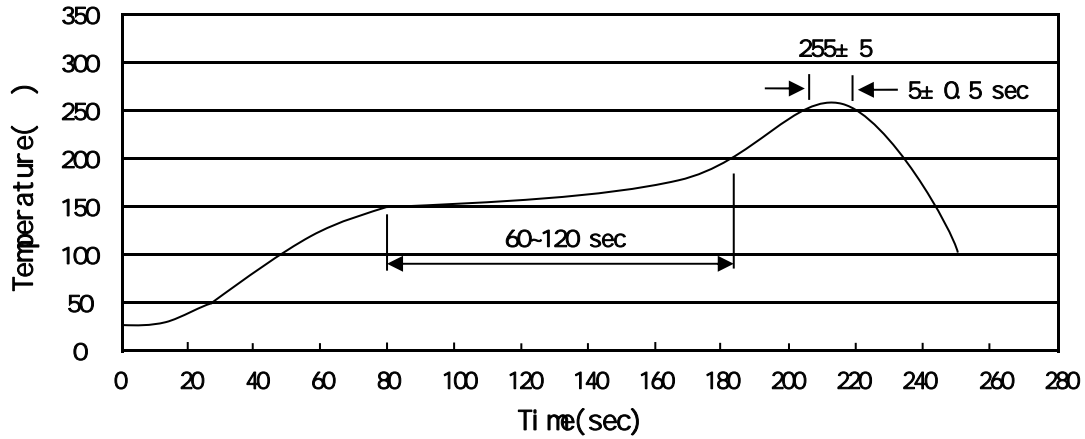

± ± ± ±

/ Resistance to Soldering Heat Test Conditions

± ±

/ Packaging SPEC.

封装形式	包装数量					包装尺寸 :		
	Units/Reel 只/卷盘	Reels/Inner Box 卷盘/盒	Units/Inner Box 只/盒	Inner Boxes/Outer Box 盒/箱	Units/Outer Box 只/箱	Reel	Inner Box 盒	Outer Box 箱
						"		

封装形式	包装数量					包装尺寸 :		
	Units/Tube 只/套管	Tubes/Inner Box 套管/盒	Units/Inner Box 只/盒	Inner Boxes/Outer Box 盒/箱	Units/Outer Box 只/箱	Tube 套管	Inner Box 盒	Outer Box 箱

/ Notices