

**/ Descriptions**

TO-126F      NPN

**/ Features**

**/ Applications**

**/ Equivalent Circuit**

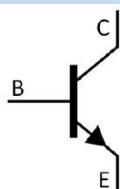

**/ Pinning**



**/ h<sub>FE</sub> Classifications & Marking**



**/ Absolute Maximum Ratings(Ta=25 )**

		°C	
			°C
			°C

**/ Electrical Characteristics(Ta=25 )**

						μ
						μ

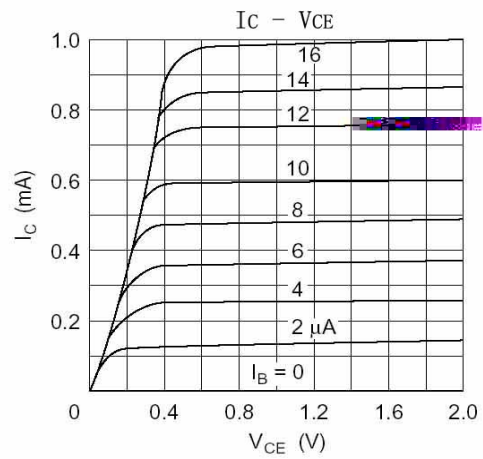
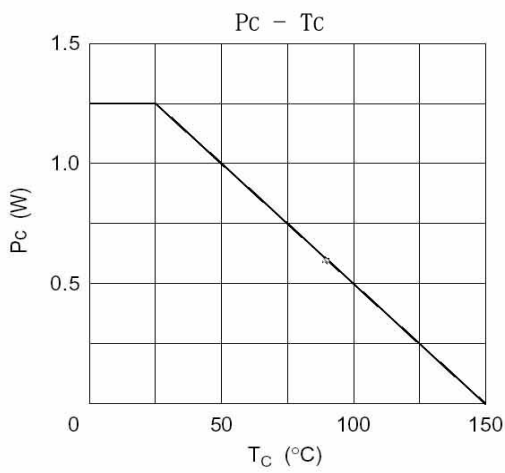
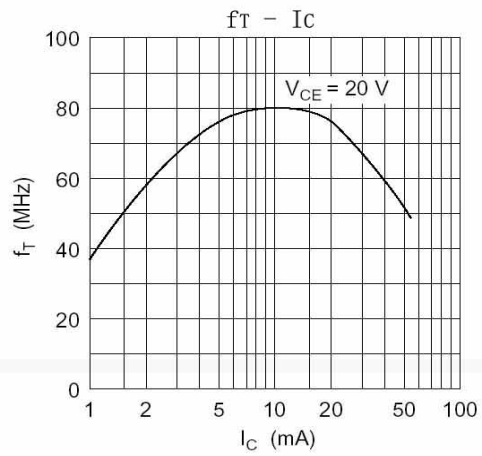
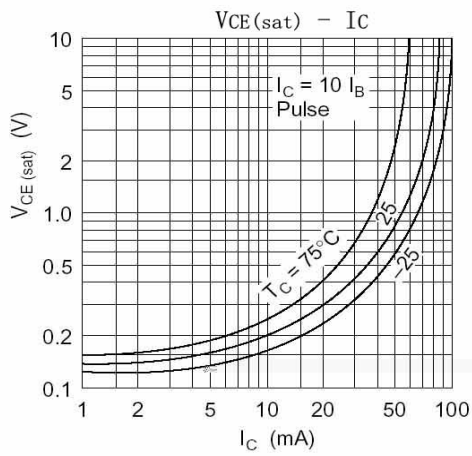
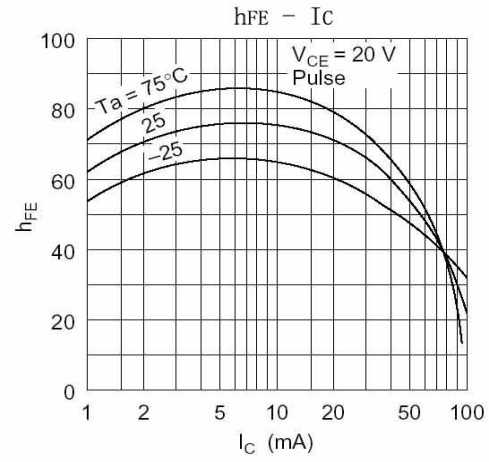
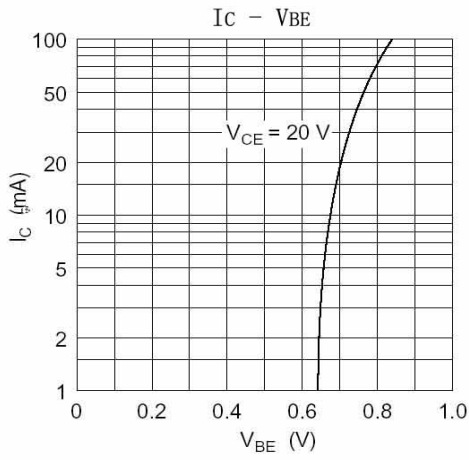
/ Electrical Characteristic Curve



/ Package Dimensions

1 2 3

单位: mm

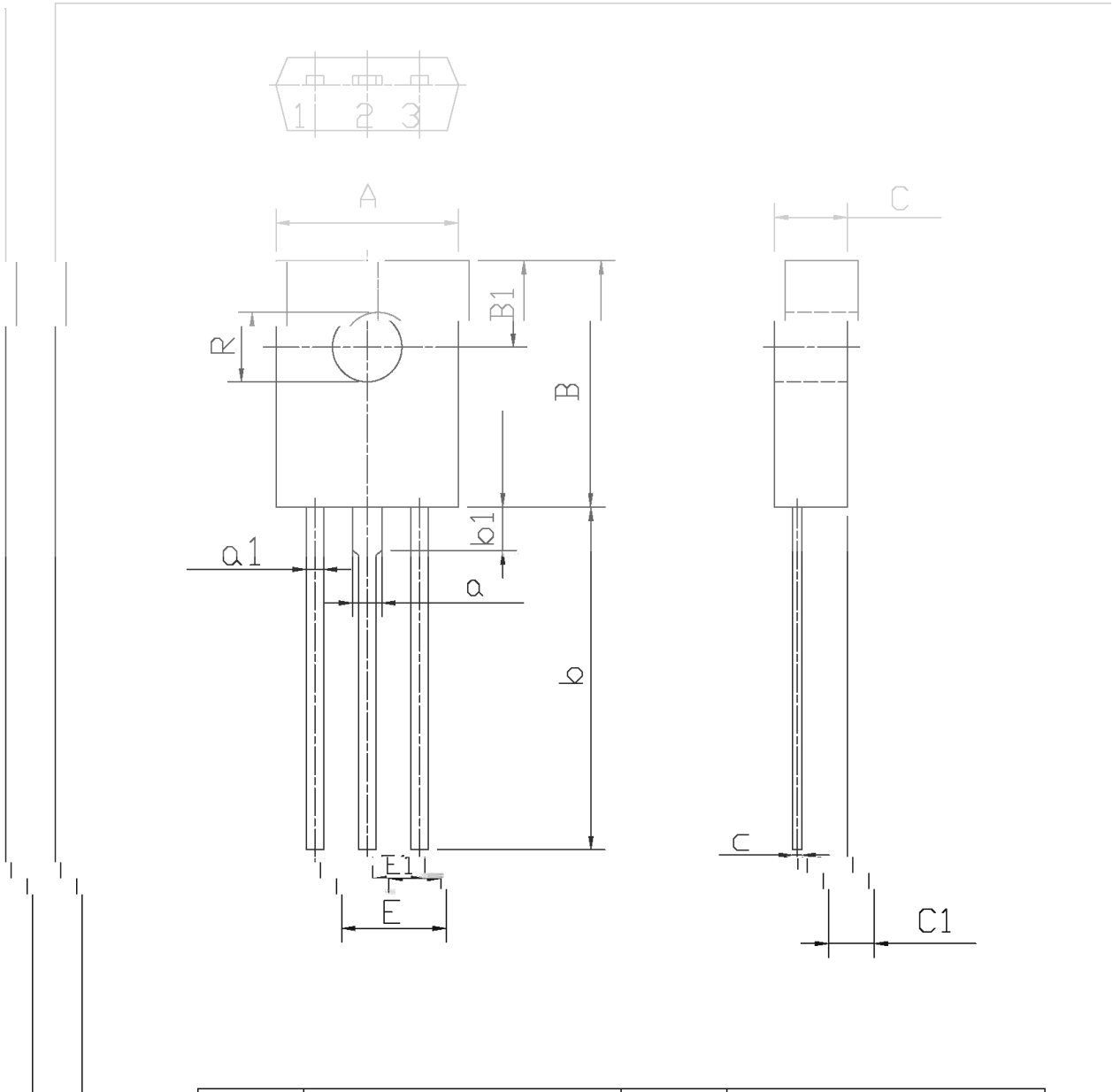

Symbol	Dimension in Millimeters		Symbol	Dimension in Millimeters	
	Min	Max		Min	Max
A	7.8	8.2	a1	0.55	0.85
B	10.0	11.2	E	4.4	4.8
B1	3.8	4.2	C	3.1	3.3
R	2.05	3.15	C1	1.9	2.1
b	14	16	c	0.3	0.6
b1	1.9		a	1.27	
E1	2.1	2.5			

/ Marking Instructions

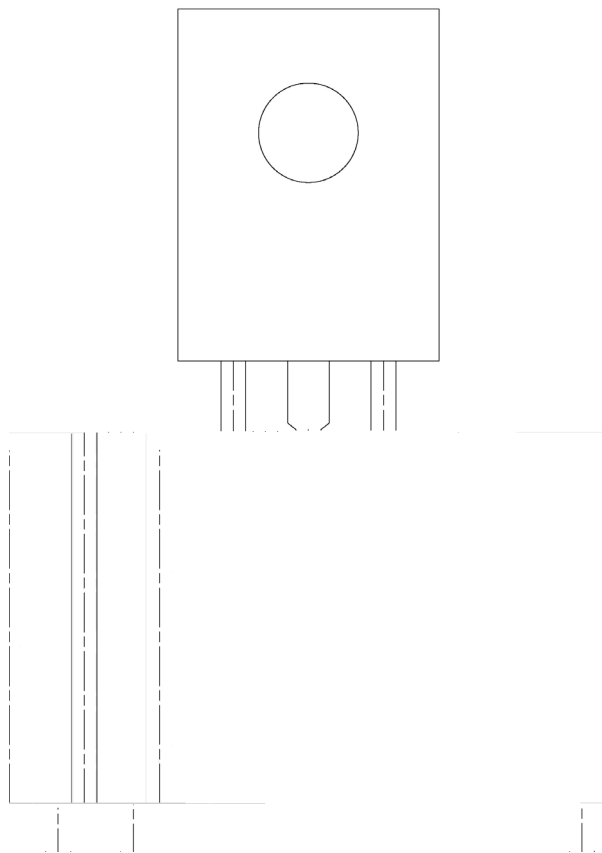

BR

C2621

C:

\*\*\*\*

$h_{FE}$

